

ANDROS ISLE PARCEL "C" PARTIAL REPLAT

(A PART OF A RESIDENTIAL PLANNED DEVELOPMENT)

BEING A REPLAT OF LOTS 35 THROUGH 126, INCLUSIVE, OF ANDROS ISLE PARCEL "C", RECORDED IN PLAT BOOK 89, PAGE 136, AND LYING IN SECTION 20, TOWNSHIP 43 SOUTH, RANGE 42 EAST, CITY OF WEST PALM BEACH, PALM BEACH COUNTY, FLORIDA



GRAPHIC SCALE
(IN FEET)
SCALE: 1" = 30'

CURVE TABLE				
C12	R=130'	CA=17°04'12"	L=38.73'	CHD=38.59'
C13	R=170'	CA=05°55'03"	L=17.56'	CHD=17.55'
C14	R=130'	CA=18°05'52"	L=41.06'	CHD=40.89'
C15	R=170'	CA=18°05'52"	L=53.70'	CHD=53.47'
C16	R=220'	CA=08°41'57"	L=33.40'	CHD=33.37'
C17	R=180'	CA=28°06'53"	L=88.32'	CHD=87.44'
C18	R=120'	CA=81°35'04"	L=170.87'	CHD=156.80'
C19	R=80'	CA=81°35'04"	L=113.91'	CHD=104.53'
C20	R=25'	CA=49°59'41"	L=21.81'	CHD=21.13'
C21	R=25'	CA=49°59'41"	L=21.81'	CHD=21.13'
C22	R=45'	CA=27°59'23"	L=219.90'	CHD=57.86'

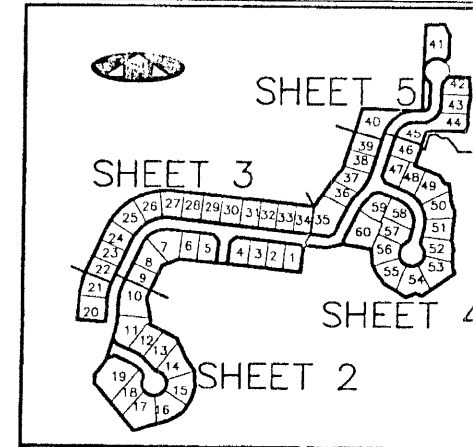

KEY MAP
(NOT TO SCALE)

LEGEND:

- (R) DENOTES A RADIAL LINE
- C/L DENOTES A CENTERLINE
- R DENOTES RADIUS DISTANCE
- L DENOTES ARC LENGTH DISTANCE
- CA DENOTES CENTRAL ANGLE
- CHD DENOTES CHORD DISTANCE
- ORB DENOTES OFFICIAL RECORDS BOOK
- PB DENOTES PLAT BOOK NUMBER
- PG DENOTES PAGE NUMBER
- SQ.FT. DENOTES SQUARE FEET
- DENOTES A SET #2424 PERMANENT REFERENCE MONUMENT (P.R.M.)
- DENOTES A SET #2424 PERMANENT CONTROL POINT (P.C.P.)
- DENOTES A FOUND #2424 PERMANENT REFERENCE MONUMENT (P.R.M.)
- ⊙ DENOTES A FOUND #2424 PERMANENT CONTROL POINT (P.C.P.)

SURVEYOR'S NOTES AND LEGEND:

- THE BASE BEARING (BB) AS SHOWN HEREON, IS N33°18'42"W ALONG THE WESTERLY BOUNDARY OF PARCEL "C", COMMON WITH THE EASTERLY RIGHT-OF-WAY LINE OF VICTORIA POINT, AS SHOWN ON THE PLAT OF ANDROS ISLE, AS RECORDED IN PLAT BOOK 81, PG. 87, PUBLIC RECORDS, PALM BEACH COUNTY, FLORIDA.
- IN THOSE INSTANCES WHERE UTILITY/DRAINAGE STRUCTURES ARE CONSTRUCTED IN CONFLICT WITH THE PLATTED PERMANENT CONTROL POINTS (P.C.P.) POSITION, STRADDLERS MONUMENTED AS PERMANENT CONTROL POINTS WILL BE SET TO REFERENCE THE PLATTED P.C.P. POSITION.
- LINE WHICH INTERSECT CURVES ARE NOT RADIAL, UNLESS OTHERWISE NOTED.

THIS INSTRUMENT WAS PREPARED BY WM. R. VAN CAUWEN, R.L.S., IN AND FOR THE OFFICES OF BENCH MARK LAND SURVEYING & MAPPING, INC., 4152 WEST BLUE HERON BOULEVARD, SUITE 121, RIVIERA BEACH, FLORIDA

BENCH MARK LAND SURVEYING & MAPPING, INC.
4152 W. BLUE HERON BOULEVARD • SUITE 121
RIVIERA BEACH • FLORIDA 33404
PHONE: (561) 848-2102 • L.B. 2171 • FAX: (561) 844-9659
E-MAIL: bmlsm@aol.com WEB: http://members.aol.com/bmlsm

RECORD PLAT			
ANDROS ISLE			
PARCEL "C" PARTIAL REPLAT			
DWN ALLEN	FB	DATE 12-18-2000	WO.# P300C
CKD	FILE P300CPL-S04	SCALE 1" = 30'	SHEET 4 OF 5

